

MAIL TO: P.O. BOX 16347 • Louisville, KY 40256-0347
 SHIP TO: 3649 Cane Run Road • Louisville, KY 40211-1961
 Tel: (502) 778-2731 • 1 (800) 928-PUMP

Visit our website:
 zoellerengineered.com

Product information presented here reflects conditions at time of publication. Consult factory regarding discrepancies or inconsistencies.



X62 HD HAZARDOUS LOCATION SERIES

CLASS I, DIVISION 1, GROUPS C & D

CLASS I, ZONE 1, GROUPS IIA & IIB

PRODUCT FEATURES

4" & 6" Flanged Discharge Units



APPLICATIONS:

- Engineered lift stations
- Storm water removal
- Wastewater transfer
- Industrial wastewater
- Hazardous locations
- WARNING: Not for use in acidic atmospheres.

SPECIFICATIONS

PUMP:

- Solids - 3" (76 mm) spherical capability
- Discharge size - 4" & 6" horizontal flanged
- Seals - dual mechanical silicon carbide / silicon carbide lower and carbon ceramic upper, Buna-N elastomers.
- Balanced concentric pump housing and impeller
- Construction - Cast iron ASTM A-48, Class 30, 30,000# tensile strength, corrosion resistant powder coated epoxy finish
- Attaching hardware - 304 stainless steel
- O-ring elastomers: Buna-N
- Impeller - 2 blade semi-open Ductile Iron with top pump out vanes
- Moisture detection system
- Optional: Silicon carbide seal 50' (15.2 m) Power and Sensor Cables
- Viton o-ring elastomers Trimmed impeller
- Vortex impeller Non-sparking rail systems
- Inverter Duty Motors (cCSAus certified with type VPWM inverter)



MOTOR:

- cCSAus rated Class I, Division 1, Groups C & D and Class I, Zone 1, Groups IIA & IIB Construction
- Tested to FM standards 3600 & 3615 by CSA
- 1 Phase - 230 Volt, 1750 RPM (5 and 7.5 BHP)
- 3 Phase - 200/230/460/575 Volt, 1750 RPM
- 5 thru 20 BHP
- Stator - Class F insulation and lead wires. NEMA B design
- Thermal sensor and leads
- Housing - Class 30 cast iron, finned, oil-filled
- Ball Bearings - upper and lower high carbon chromium steel
- Power cable length - 25' (7.6 m)

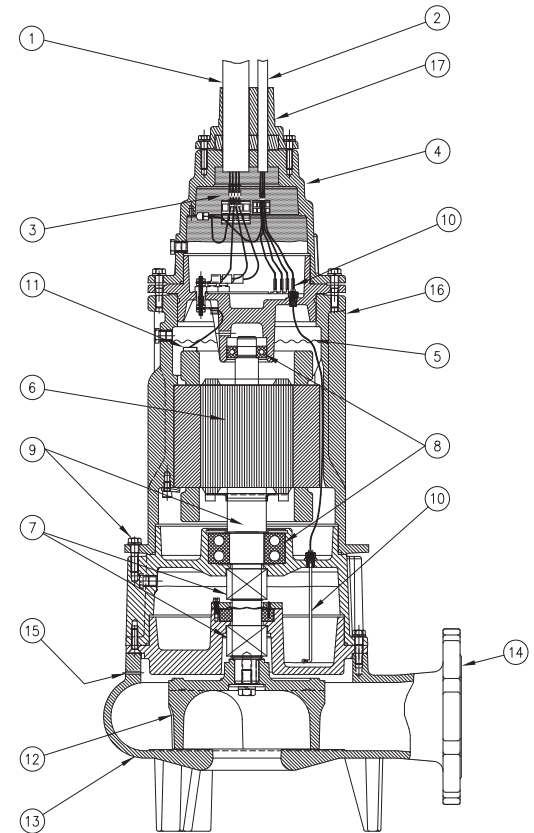

ZEPB0626

FEATURES:

- 25' (7.6 m) of extra heavy duty power cable. 50' (15.2 m) optional
- 25' (7.6 m) sensor cable. 50' (15.2 m) optional
- Specially designed splices and potted cord entry system provides strain relief and prevents wicking of liquids into the housing.
- Lifting lugs integral part of housing (not shown)
- Oil-filled motor housing with finned casting assures uniform heat distribution, lubricates bearings, and conducts heat for cooler running.
- Heavy duty motor features ball bearing construction. Class F motor insulation is double dipped and baked. End connections and lead wires are Class F. At maximum load, winding temperature will not exceed 250 °F (121 °C) with motor housing not submerged.
- Tandem seals. Silicon carbide / silicon carbide lower and carbon ceramic upper, Buna-N elastomers.
- Upper and lower high carbon chromium steel ball bearings
- Stainless steel shaft and hardware resists corrosion
- Patented moisture detection system with upper and lower probes, protecting the motor from liquid entry.
- Thermal sensor will deactivate pump if internal motor temperature reaches 250 °F (121 °C) when connected to panels.
- Balanced 2 vane semi-open impeller with top pump out vanes for seal protection keyed and bolted to shaft. Recessed vortex design also available as an option.
- Concentric volute reduces radial loading for longer bearing and shaft seal life.
- 4" or 6" flanged horizontal discharge
- Vent hole helps prevent air lockin
- Entire unit protected with a corrosion resistant powder coated epoxy finish
- 2-1/2" male NPT conduit connection

For additional information on the X62 HD Series pumps, refer to catalog on performance information, ZM2440; dimensional data information, ZM2531 and ZM2532; guide specifications, ZM2535; and owner's manual, ZM2454.

For information on additional Zoeller products refer to catalog on rail systems and lifting cable, ZM1347; control panels, ZM1342; float switches, and switch brackets, ZM1328; valves and piping accessories, ZM1348.