

MAIL TO: P.O. BOX 16347 • Louisville, KY 40256-0347  
 SHIP TO: 3649 Cane Run Road • Louisville, KY 40211-1961  
 Tel: (502) 778-2731 • 1 (800) 928-PUMP

Visit our website:  
 zoellerengineered.com

Product information presented here reflects conditions at time of publication. Consult factory regarding discrepancies or inconsistencies.

## X71 HD HAZARDOUS LOCATION SERIES

CLASS I, DIVISION 1, GROUPS C & D

CLASS I, ZONE 1, GROUPS IIA & IIB

GRINDER PUMP PRODUCT FEATURES

3, 5 & 7-1/2 HP



Covered by US Patent Number 6,364,620.

### APPLICATIONS

- Sewage lift stations.
- Housing developments.
- Low pressure sewer systems.
- High vertical lift or long force mains.
-  **WARNING:** Not for use in acidic atmospheres.

### MATERIAL FEATURES PUMP:

- 440 stainless steel cutter and plate hardened to Rockwell C55-60.
- Discharge size - 2-1/2" flanged horizontal adaptable to 3" flange, 2" NPT optional.
- Seals - dual mechanical silicon carbide / silicon carbide lower and carbon ceramic upper, Buna-N elastomers.
- Moisture detection system.
- Construction - Cast iron ASTM A-48, Class 30, 30,000# tensile strength, protected with a corrosion resistant baked on epoxy powder coating.
- Balanced concentric pump housing and impeller.
- Attaching hardware - 304 stainless steel.
- Square ring seals - Buna-N.
- Impeller - Ductile iron vortex design.
- Optional:
 

<input type="checkbox"/> Trimmed impeller.	<input type="checkbox"/> High flow.
<input type="checkbox"/> Silicon carbide seal	<input type="checkbox"/> Automatic Reversing -
<input type="checkbox"/> 50' (15.2 m) power and sensor cables.	(3-Phase Flanged Models Only).
<input type="checkbox"/> Viton square ring seals	<input type="checkbox"/> Non-sparking rail system.
<input type="checkbox"/> 2" NPT vertical discharge - HH & HF only.	

### MOTOR:

- cCSAus rate Class I, Division 1, Groups C & D and Class I, Zone 1, Groups IIA & IIB Construction
- Tested to FM Standards 3600 & 3615 by CSA
- 1 Phase - 230 Volt (3 & 5 HP only).
- 3 Phase - 200/230/460/575 Volt, 3450 RPM.
- Stator - Class F insulation and lead wires. Nema B design.
- Thermal sensor with leads.
- Housing - Cast iron, oil-filled.
- Ball bearings - Upper and lower high carbon chromium steel.
- Power and sensor cable length - 25' (7.6 m).

### FEATURES:

1. 25' heavy duty power cable.
2. Protected cable entrance.
3. Each conductor is individually sealed to eliminate cord wicking of liquids.
4. Lifting lug integral part of housing (orientation 90° from illustrated view).
5. Oil-filled explosion proof rated motor housing assures uniform heat distribution, lubricates bearings, and conducts heat for cooler running.
6. Heavy duty explosion proof rated motor features ball bearing construction. Class F motor insulation is double dipped and baked. End connections and lead wires are Class F. At maximum load, winding temperature will not exceed 250 °F (121 °C) with motor housing not submerged.
7. Tandem seals, silicon carbide / silicon carbide lower and carbon ceramic upper, Buna-N elastomers.
8. Upper and lower high carbon chromium steel ball bearings.
9. Stainless steel shaft and hardware resists corrosion.
10. Patented moisture detection system with upper and lower probes, protecting the motor from liquid entry.
11. Thermal sensor protection.
12. 25' (7.6 m) sensor cable.
13. Ductile iron vortex impeller design, bronze optional, fully balanced with integral pump out vane to clear debris.
14. "Star" type stainless steel cutter and plate hardened to Rockwell C55-60.
15. Concentric case reduces radial loading for longer bearing and seal life.
16. 2-1/2" flanged horizontal discharge adaptable to 3" flange. Optional 2" NPT vertical discharge available for HH and HF models.
17. Vent hole helps prevent air locking.
18. Screw on pipe legs for field flexibility.
19. Class 30 cast iron housing protected with corrosion resistant baked on epoxy powder coating.
20. Finned motor housing for quicker heat dissipation.

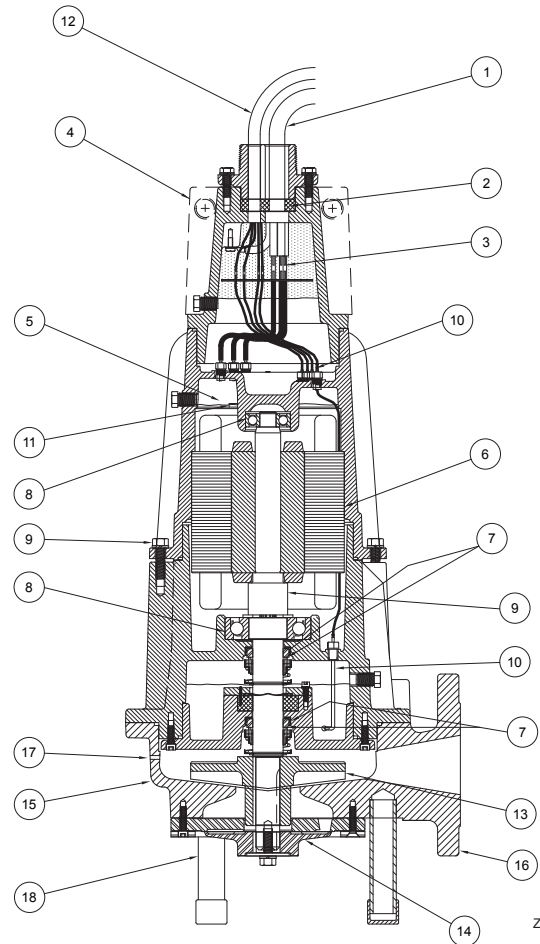

ZEPA0557