

Product information presented here reflects conditions at time of publication. Consult factory regarding discrepancies or inconsistencies.



61 HD SERIES

PRODUCT FEATURES

3" Vertical Discharge Units



APPLICATIONS

- Engineered Lift Stations
- Storm Water Removal
- Wastewater Transfer
- Industrial Wastewater

MATERIAL FEATURES

PUMP:

- Solids - 2-1/2" spherical capability
- Discharge Size - 3" NPT Vertical
- Seals - dual mechanical silicon carbide / silicon carbide lower and carbon ceramic upper, Buna-N elastomers.
- Construction - Cast Iron ASTM A-48, Class 30, 30,000# tensile strength, protected with a corrosion resistant baked on epoxy powder coating
- Balanced concentric pump housing and impeller
- Attaching Hardware - 304 stainless steel
- O-ring Seals: Buna-N
- Ductile Iron Impeller - 2 blade semi-open with top pump out vanes
- Moisture detection system
- Optional:

- ☐ Trimmed impeller
- ☐ Vortex impeller
- ☐ Additional cord length ____ ft.
- ☐ 3450 RPM high head unit
- ☐ High temperature construction (1-3 BHP, not CSA listed)

- ☐ Rail systems
- ☐ Silicon carbide seal
- ☐ Viton O-ring elastomers
- ☐ Inverter duty motor - (1-5 BHP, cCSAus certified for VPWM type 30 Hz to 60 Hz max, 1750 RPM only)

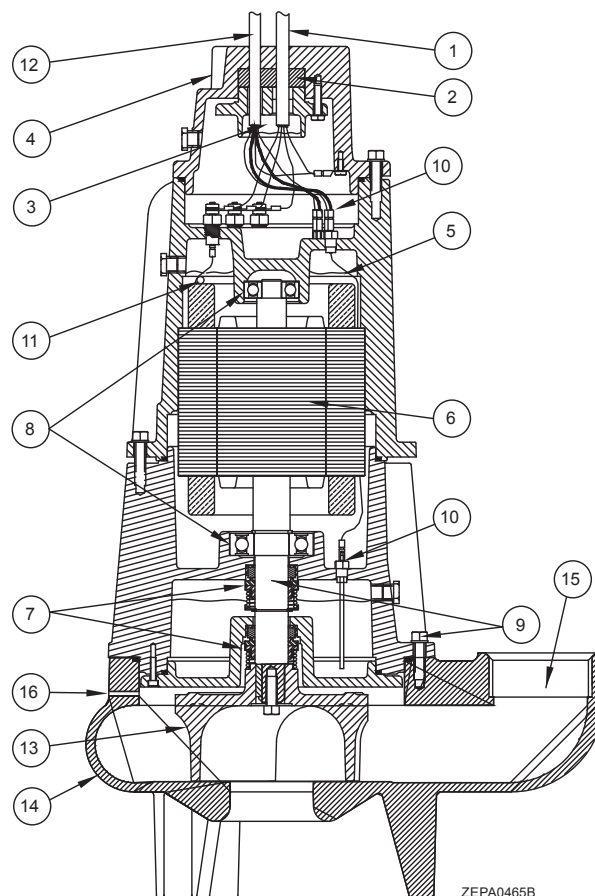

ZEP40465B

MOTOR:

- 1 Phase - 230 Volt, 1750 RPM
- 3 Phase - 200/230/460/575 Volt, 1750 RPM
- Stator - Class F insulation and lead wires NEMA B design.
- Oil-filled motor housing
- Finned cast iron housing for faster heat dissipation
- Ball Bearings - Dual high carbon chromium steel
- Power Cable Length - 25'

ENGINEERING FEATURES:

1. 25' of heavy duty power cable
2. Protected cable entrance. The compression grommet allows for field replacement of the cable.
3. Each conductor is individually sealed to eliminate cord wicking of liquids
4. Lifting lug integral part of housing
5. Oil-filled motor housing assures uniform heat distribution, lubricates bearings, and conducts heat for cooler running
6. Heavy duty motor features ball bearing construction. Class F motor insulation is double dipped and baked. End connections and lead wires are Class F. At maximum load, winding temperature will not exceed 250 °F with motor housing not submerged.
7. Tandem seals, Silicon carbide / silicon carbide lower and carbon ceramic upper, Buna-N elastomers.
8. Upper and lower high carbon chromium steel ball bearings
9. Stainless steel shaft and hardware resists corrosion
10. Patented moisture detection system with upper and lower probes, protecting the motor from liquid entry.

11. Thermal sensor protection. Motors have 2 normally closed temperature sensors imbedded in windings.
12. 25' sensor cable
13. Balanced Ductile Iron 2 vanes semi-open impeller with top pump out vanes for seal protection. Keyed and bolted to shaft
14. Concentric case reduces radial loading for longer bearing and seal life
15. 3" NPT vertical discharge
16. Vent hole helps prevent air locking
17. Units protected with corrosion resistant baked on epoxy powder coating

For additional information on 61 HD Series pumps, refer to catalog on Technical and Performance data ZM1750 (1750 RPM) or ZM1752 (3450 RPM); Dimensional Data ZM1755; Guide Specifications ZM1743; Replacement Parts ZM1760; and Owners Manual ZM1759.

For information on additional Zoeller products refer to catalog on Rail Systems, ZM1347; Control Panels, ZM1342; Float Switches and J-Boxes, ZM1536; Float Switch Brackets, ZM1328; Pump Lifting Cables, ZM1328; Check Valves and Piping Accessories, ZM1348.

61 HD SERIES PRODUCT FEATURES

3" & 4" Flanged Horizontal Discharge Units



APPLICATIONS

- Engineered Lift Stations
- Storm Water Removal
- Wastewater Transfer
- Industrial Wastewater



SPECIFICATIONS

PUMP:

- Solids - 2-1/2" spherical capability
- Discharge Size - 3" & 4" Flanged horizontal
- Seals - dual mechanical silicon carbide / silicon carbide lower and carbon ceramic upper, Buna-N elastomers.
- Construction - Cast Iron ASTM A-48, Class 30, 30,000# tensile strength, protected with a corrosion resistant baked on epoxy powder coating
- Balanced concentric pump housing and impeller
- Attaching Hardware - 304 stainless steel
- O-ring Seals: Buna-N
- Ductile Iron Impeller - 2 blade semi-open with top pump out vanes
- Moisture detection system
- Optional:

- | | |
|--|--|
| <input type="checkbox"/> Trimmed impeller | <input type="checkbox"/> 3450 rpm high head units |
| <input type="checkbox"/> Vortex impeller | <input type="checkbox"/> Dry pit configuration |
| <input type="checkbox"/> 3" Solids capacity | <input type="checkbox"/> (1-3 bhp, not csa listed) |
| <input type="checkbox"/> (4" Discharge units only) | <input type="checkbox"/> High temperature construction |
| <input type="checkbox"/> Silicon carbide seal | <input type="checkbox"/> (1-3 bhp, not csa listed) |
| <input type="checkbox"/> Viton o-ring elastomers | <input type="checkbox"/> Additional cord length ____ ft. |
| <input type="checkbox"/> Rail systems | <input type="checkbox"/> Inverter duty motor -(1-5 BHP, cCSAus |
| | certified for VPWM type 30 Hz to |
| | 60 Hz max, 1750 RPM only) |

MOTOR:

- 1 Phase - 230 Volt, 1750 RPM
- 3 Phase - 200/230/460/575 Volt, 1750 RPM
- Stator - Class F insulation and lead wires
- NEMA B design
- Housing - Cast Iron, oil-filled
- Ball Bearings - Dual high carbon chromium steel
- Power Cable Length - 25'

FEATURES:

- | | |
|--|---|
| 1. 25' of heavy duty power cable | 12. 25' sensor cable |
| 2. Protected cable entrance. The compression grommet allows for field replacement of the cable. | 13. Balanced Ductile Iron 2 vanes semi-open impeller with top pump out vanes for seal protection. Keyed and bolted to shaft |
| 3. Each conductor is individually sealed to eliminate cord wicking of liquids. | 14. Concentric case reduces radial loading for longer bearing and seal life. |
| 4. Lifting lug integral part of housing | 15. 3" or 4" flanged horizontal discharge |
| 5. Oil-filled motor housing assures uniform heat distribution, lubricates bearings, and conducts heat for cooler running. | 16. Vent hole helps prevent air locking |
| 6. Heavy duty motor features ball bearing construction. Class F motor insulation is double dipped and baked. End connections and lead wires are Class F. At maximum load, winding temperature will not exceed 250 °F with motor housing not submerged. | 17. Unit protected with corrosion resistant baked on epoxy powder coating. |
| 7. Tandem seals, Silicon carbide / silicon carbide lower and carbon ceramic upper, Buna-N elastomers. | |
| 8. Upper and lower high carbon chromium steel ball bearings | |
| 9. Stainless steel shaft and hardware resists corrosion | |
| 10. Patented moisture detection system with upper and lower probes, protecting the motor from liquid entry. | |
| 11. Thermal sensor protection. Motors have 2 normally closed temperature sensors imbedded in windings. | |

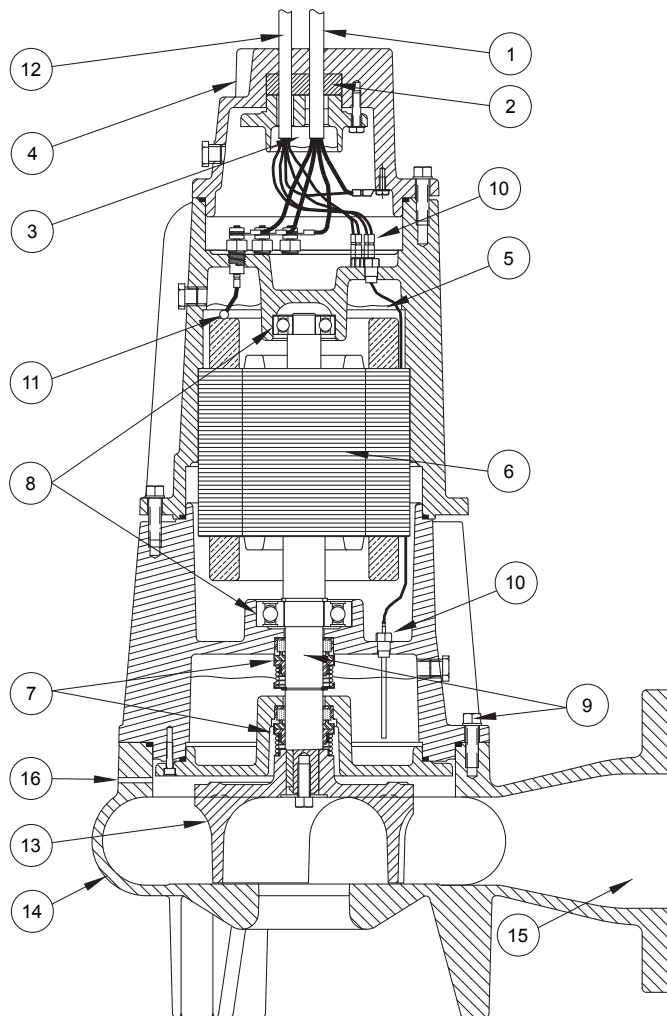

ZEPA0462B

For additional information on 61 HD Series pumps, refer to catalog on Technical and Performance data ZM1750 (1750 RPM) or ZM1752 (3450 RPM); Dimensional Data ZM1756, ZM1757, ZM1758, ZM1759; Guide Specifications ZM1743; Replacement Parts ZM1760; and Owners Manual ZM1759.

For information on additional Zoeller products refer to catalog on Rail Systems, ZM1347; Control Panels, ZM1342; Float Switches and J-Boxes, ZM1536; Float Switch Brackets, ZM1328; Pump Lifting Cables, ZM1328; Check Valves and Piping Accessories, ZM1348.