

Trusted. Tested. Tough.®

SECTION: Z3.40.100

ZM2439

0521

Supersedes

0820

Product information presented here reflects conditions at time of publication. Consult factory regarding discrepancies or inconsistencies.



MAIL TO: P.O. BOX 16347 • Louisville, KY 40256-0347
SHIP TO: 3649 Cane Run Road • Louisville, KY 40211-1961
(502) 778-2731 • 1 (800) 928-PUMP • FAX (502) 774-3624

Visit our website:
zoellerengineered.com



X62 HD HAZARDOUS LOCATION SERIES

CLASS I, DIVISION 1, GROUPS C & D

CLASS I, ZONE 1, GROUPS IIA & IIB

PRODUCT FEATURES

4" & 6" Flanged Discharge Units



APPLICATIONS:

- Engineered lift stations
- Storm water removal
- Wastewater transfer
- Industrial wastewater
- Hazardous locations
-  **WARNING:** Not for use in acidic atmospheres.

SPECIFICATIONS PUMP:

- Solids - 3" (76 mm) spherical capability
- Discharge size - 4" & 6" horizontal flanged
- Seals - dual mechanical carbon/rotary, ceramic/stationary, Buna-N elastomers
- Balanced concentric pump housing and impeller
- Construction - Cast iron ASTM A-48, Class 30, 30,000# tensile strength, corrosion resistant powder coated epoxy finish
- Attaching hardware - 304 stainless steel
- O-ring elastomers: Buna-N
- Impeller - 2 blade semi-open Ductile Iron with top pump out vanes
- Moisture detection system
- Optional:

<input type="checkbox"/> Silicon carbide seal(s)	<input type="checkbox"/> 50' (15.2 m) Power and Sensor Cables
<input type="checkbox"/> Viton o-ring elastomers	<input type="checkbox"/> Trimmed impeller
<input type="checkbox"/> Vortex impeller	<input type="checkbox"/> Non-sparking rail systems
<input type="checkbox"/> Bronze impeller	<input type="checkbox"/> Inverter Duty Motors (cCSAus certified with type VPWM inverter)



MOTOR:

- cCSAus rated Class I, Division 1, Groups C & D and Class I, Zone 1, Groups IIA & IIB Construction
- Tested to FM standards 3600 & 3615 by CSA
- 1 Phase - 230 Volt, 1750 RPM (5 and 7.5 BHP)
- 3 Phase - 200/230/460/575 Volt, 1750 RPM
- 5 thru 20 BHP
- Stator - Class F insulation and lead wires. NEMA B design
- Thermal sensor and leads
- Housing - Class 30 cast iron, finned, oil-filled
- Ball Bearings - upper and lower high carbon chromium steel
- Power cable length - 25' (7.6 m)



FEATURES:

1. 25' (7.6 m) of extra heavy duty power cable. 50' (15.2 m) optional
2. 25' (7.6 m) sensor cable. 50' (15.2 m) optional
3. Specially designed splices and potted cord entry system provides strain relief and prevents wicking of liquids into the housing.
4. Lifting lugs integral part of housing (not shown)
5. Oil-filled motor housing with finned casting assures uniform heat distribution, lubricates bearings, and conducts heat for cooler running.
6. Heavy duty motor features ball bearing construction. Class F motor insulation is double dipped and baked. End connections and lead wires are Class F. At maximum load, winding temperature will not exceed 250 °F (121 °C) with motor housing not submerged.
7. Tandem seals, carbon/rotating, ceramic/stationary, Buna-N elastomers. Optional seal materials available.
8. Upper and lower high carbon chromium steel ball bearings
9. Stainless steel shaft and hardware resists corrosion
10. Patented moisture detection system with upper and lower probes, protecting the motor from liquid entry.
11. Thermal sensor will deactivate pump if internal motor temperature reaches 250 °F (121 °C) when connected to panels.
12. Balanced 2 vane semi-open impeller with top pump out vanes for

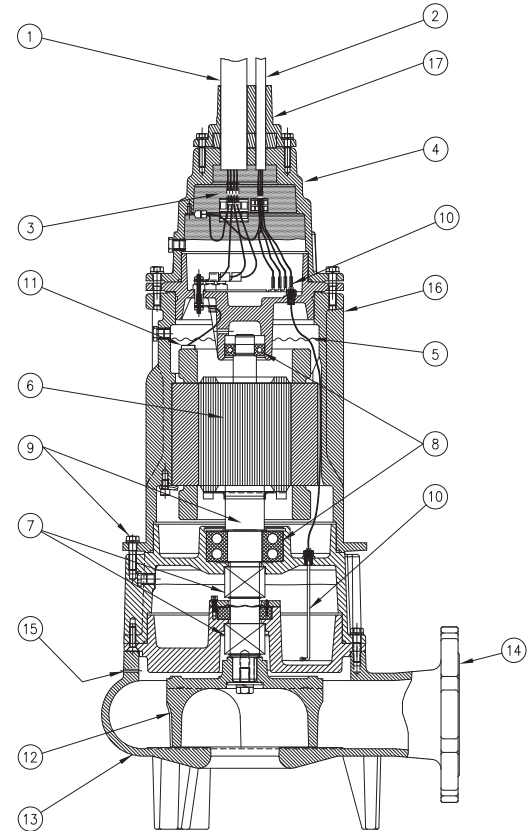

ZEPB0626

seal protection keyed and bolted to shaft. Recessed vortex design also available as an option.

13. Concentric volute reduces radial loading for longer bearing and shaft seal life.
14. 4" or 6" flanged horizontal discharge
15. Vent hole helps prevent air lockin
16. Entire unit protected with a corrosion resistant powder coated epoxy finish
17. 2-1/2" male NPT conduit connection

For additional information on the X62 HD Series pumps, refer to catalog on performance information, ZM2440; dimensional data information, ZM2531 and ZM2532; guide specifications, ZM2535; and owner's manual, ZM2454.

For information on additional Zoeller products refer to catalog on rail systems and lifting cable, ZM1347; control panels, ZM1342; float switches, and switch brackets, ZM1328; valves and piping accessories, ZM1348.